

# ENDLESS SUMMER

SPECIFICATIONS



## TABLE OF CONTENTS

CONTACT	2
INTRODUCTION	3
MAIN CHARACTERISTICS	3
CONSTRUCTION	4
PERFORMANCE	4
TANKAGE	4
MACHINERY	4
STABILISERS	4
MECHANICAL	4
ELECTRICAL	4
NAVIGATION EQUIPMENT	4
COMMUNICATION EQUIPMENT	4
DOMESTIC APPLIANCES, EQUIPMENT AND LAUNDRY	4
ACCOMMODATION	4
TENDERS & TOYS	4
WORKLIST 2022/2023	5
LEGAL DISCLAIMER	5
GENERAL ARRANGEMENT	6
EXTERIOR GALLERY	7
DECKS GALLERY	8
INTERIOR GALLERY	9



CONTACT



**TOM BARNES**  
SALES BROKER

Phone

+33 620 18 17 34

Email

Tom@bluewateryachting.com



## INTRODUCTION

ENDLESS SUMMER presents an amazing opportunity for a buyer looking for a tri-deck motor yacht with renowned Benetti pedigree and incredible interior and exterior space. This 2006 Benetti Tradition 100 tri-deck motor yacht was designed by Francois Zuretti and Stefano Righini and has been immaculately maintained with the most recent refit in 2022/23. She features expansive deck spaces across three decks with al fresco dining on two decks with bar, multiple shaded lounging options plus Jacuzzi, and a modern, elegant interior with recent upgrades throughout. ENDLESS SUMMER has spacious accommodations for nine guests in four staterooms. Her on-deck master stateroom offers 180-degree views and total privacy. The full-beam VIP stateroom has an ensuite and is also privately accessed. The two other guest staterooms, one double and a twin with Pullman are midships on the lower deck. ENDLESS SUMMER is powered by the preferred package of reliable Caterpillar C18 main engines and has 3 cabins for 5 crew.

**ASKING PRICE:** € 2,950,000

VAT UNPAID



## MAIN CHARACTERISTICS

Builder	Benetti	Guests	9
Year	2006	Staterooms	4
Refit	2023	Naval Architect	Benetti
LOA (M/FT)	30.20m / 99'2"	Exterior Designer	Stefano Righini
Beam (M/FT)	7.15m / 23'5"	Interior Designer	François Zuretti
Draft (M/FT)	1.90m / 6'3"	Cruising speed	13 knots
Hull	Composite	Max speed	15 knots
Gross Tonnage	193	Range	2100 @ 13 knots
Flag	Cayman Islands	Engines	2 x CAT C18 1050 hp
Crew	5	Lying	St Raphael, France

**CONSTRUCTION**

Hull / Superstructure	Composite / Composite
Deck material	Teak
External Designer	Stefano Righini
Internal Designer	Francois Zuretti
Naval Architect	Azimut-Benetti Spa

**PERFORMANCE**

Cruising Speed	13 knots
Maximum Speed	15 knots
Range (nm)	2100nm

**TANKAGE**

Fuel	21,000 l
Lubrication oil	250 l
Fresh water	4,900 l
Grey water	1,640 l
Black water	1,640 l

**MACHINERY**

Engines	2xCATC181050hp
Engine hours	4000 (November 2023)
Generators	2 x Kohler 55 Kw (rebuilt in 2021)
Generator hours	15400 (November 2023)

**STABILISERS**

Stabilisers underway	Naiad Multisea II -Fin
----------------------	------------------------

**MECHANICAL**

Fuel separator	Alfa Laval
Toilet system	Jets
Bow thruster	Naiad
Water maker	Idromar 320
Air-conditioning	Condaria Central System
Waste water treatment	Hamman
Oily water separator	Alfa
Toilet system	Jets

**ELECTRICAL**

Voltage	380-220-24 V
Frequency	50 Hz
Shore power converter	380
Batteries	Mastervolt (Mass 24/75 Mass 24/25 X 2) V/Ah

**NAVIGATION EQUIPMENT**

Magnetic compass	1
Gyro compass	1
Depth sounder	Furuno
Autopilot	Simrad A2004
Radar	2 x Furuno
Electronic chart system	Furuno Navnet
GPS	Furuno GP32

**COMMUNICATION EQUIPMENT**

Navtex	Furuno NX700
VHF	Sailor 6222
MF/HF	Sailor H4500

**DOMESTIC APPLIANCES,  
EQUIPMENT AND LAUNDRY**

Refrigerator	General Electric Twin Door
Freezer	Arcelik
Oven	Miele
Microwave	Miele
Icemaker	Samsung
Dishwasher	Siemens
Washing machine	Miele
Dryer	Miele

**ACCOMMODATION**

4 ensuite guest cabins for 9 guests
Full beam Master on Main deck
Full beam VIP with private access on lower deck aft
Double cabin and twin cabin with Pullman on lower deck midships
3 ensuite crew cabins for 5 crew
Captain's cabin and 2 twin crew cabins on lower deck forward

**TENDERS & TOYS**

Novurania 4.20 m with Yamaha 50HP outboard
--

WORKLIST 2022/2023

Service Main engines and generators	Update and service of Autronica fire detection system, installation of 2 new gas detectors in the garage
Service of Alfa Lava and Idromar watermaker	Installed wireless remotes for anchor winches
Changed 13 thru-hull fittings	New sun tents for Skydeck, Flybridge and Main deck incl. SS poles
Repair of underwater lights	New covers for outside cushions plus protective covers
Antifouling and Prospeed application	New circulation pumps Jacuzzi (4 pumps)
Service of all Firefighting and Life Saving Appliances	2 new digital Main Engine monitors wheelhouse
Installation of 2 new life rafts incl. cradles	Repaired salon sliding door
Service of all pumps	New high-pressure pump watermaker
Exchanged all interior lights to LED dimmable	Kitchen food elevator and stewardess call system repaired
Changed deckhead fabric in salon and Master cabin	2 new outdoor shower boxes (Jacuzzi and Aft deck)
New TVs and iPads with Crestron app to control Audio/video, lights and blinds	Changed all push locks of drawers and doors
New curtains throughout the yacht	Replaced BBQ vent
New sofa and chairs in the salon	2 new electronic boards AC plus service and repair of 4 fancoils and installed new filters
New carpet throughout the yacht	Service of Hamann pumps
New showerheads in all showers and new faucets in galley, pantry and flybridge bar	Full wax and polish of the yacht
New magnetic locks and new lock for sliding door pantry and 2 sliding doors galley incl 4 new dampers	Repair of teak decks

LEGAL DISCLAIMER

These particulars have been prepared by Bluewater from information provided and obtained from sources believed to be correct but are not guaranteed. This information is intended as a general guide to the vessel. Bluewater cannot, however, be liable for any inaccuracy. It is up to the purchaser to confirm details of concern to him by survey, inspection and enquiry of the seller and to ensure that the purchase contract properly reflects one's concern and specific details upon which one may rely. All information in this document is provided in good faith but not binding for legal reasons.



# GENERAL ARRANGEMENT

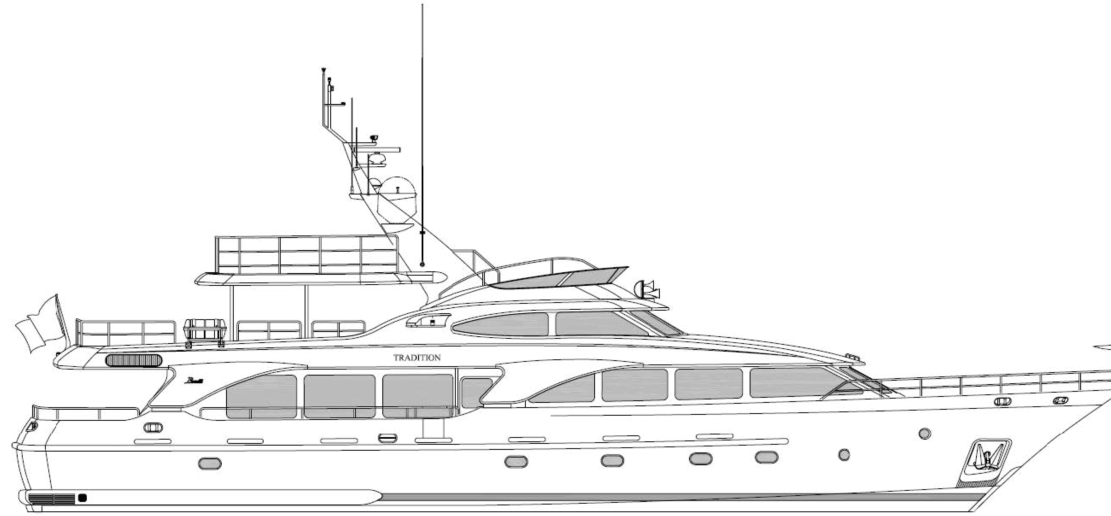

Profile

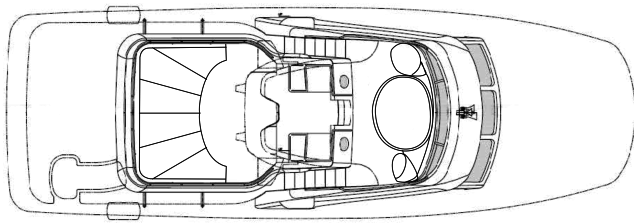

Flying bridge

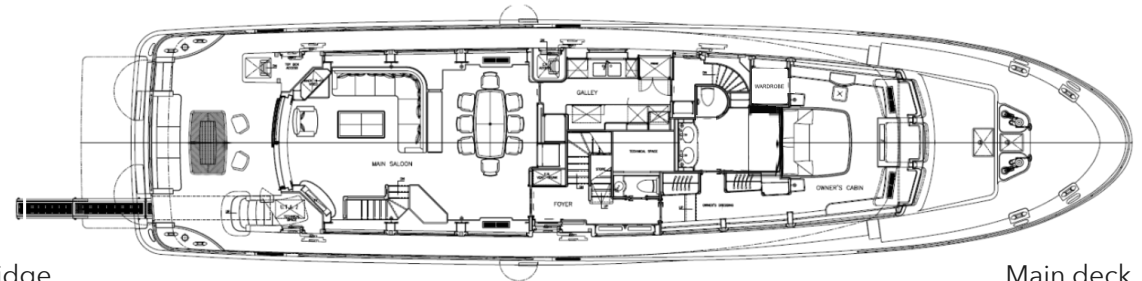

Main deck

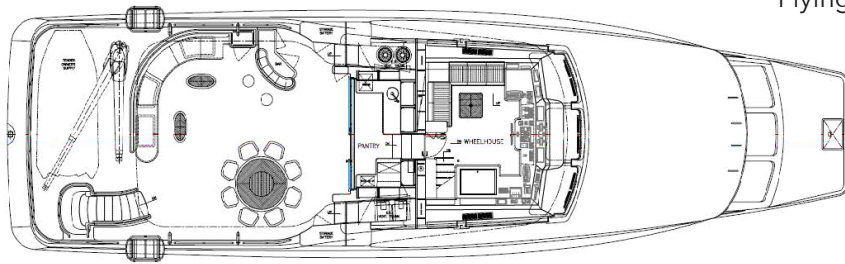

Bridge deck

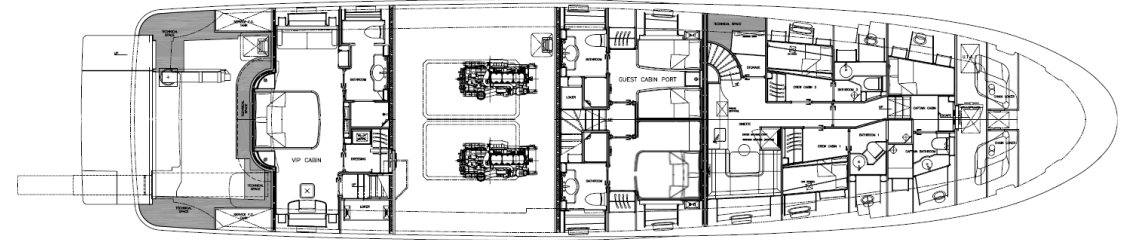

Lower deck

# EXTERIOR



*Benetti*  
ITALIAN EXCELLENCE SINCE 1873





# DECKS





# INTERIOR





ENDLESS SUMMER

